

MAXXON®

Acousti-Mat® SBR

TECHNICAL DATA SHEET
APRIL 2023

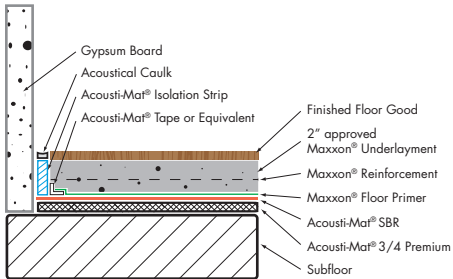

PRODUCT DESCRIPTION

Maxxon® Acousti-Mat® SBR is a styrene butadine rubber mat used as part of the Acousti-Mat Double Mat System. When paired with Maxxon® Acousti-Mat® 3/4 Premium, the double mat system offers superior sound control for even the most challenging assemblies.

WHERE TO USE

Application

Multifamily, mass timber construction, open beam construction.

Subfloor

Interior wood.

FEATURES & BENEFITS

- Pair with Maxxon Acousti-Mat 3/4 Premium for a robust sound control
- Recommended for use in Mass Timber Construction or Heavy Timber Open Beam Construction

PRODUCT INFORMATION

Thickness	3/8 in. (10 mm)
Color	Beige
Underlayment Depth with Maxxon® Reinforcement	Minimum 2 in. (51 mm)
Roll Width	54 in.
Roll Length	30 ft
Sq. Ft. per Roll	135 ft ² (12.5 m ²)
Sq. Yds per Roll	15
Weight	100 lbs/roll
Rolls per Truck	440

INSTALLATION

Surface Preparation

The subfloor shall be structurally sound, fully dry, cleaned free of mud, oil, grease, dirt, dust and other contaminating factors.

Application

After installation of Acousti-Mat 3/4 Premium, Acousti-Mat SBR is rolled out over entire floor and taped with minimum of 2 in. width tape at the seams.

Top with Maxxon Reinforcement and a minimum of 2 in. (51 mm) approved Maxxon® underlayment.

LIMITATIONS

For questions regarding these limitations or for applications other than those described herein, contact Maxxon Corporation at (800) 356-7887.

1. For interior use only.
 2. Fasteners such as, but not limited to, screws, nails or staples used to attach Maxxon Acousti-Mat SBR to wood subfloors can negatively affect sound performance.
 3. Do not use adhesives of any kind.
 4. Do not use where Maxxon Acousti-Mat SBR will come in prolonged contact with water or water vapor unless special ordered for exterior applications. Contact Maxxon for more information.
 5. Maxxon sound mats and underlayments are non-structural and therefore cannot be expected to reinforce structurally deficient subfloors. The structural floor and joist must not exceed L/240 from combined dead and live loads and L/360 from live loads. Some floor coverings may require more restrictive deflection limits. Determining the appropriate structural design of the floor is not the responsibility of Maxxon nor the Maxxon applicator.
-

STORAGE AND DISPOSAL

Keep in a dry, cool place. Maxxon Acousti-Mat SBR is not considered hazardous per US-GHS requirements and may be disposed of with day-to-day construction materials.

WARRANTY AND TECH SERVICES

Contact Maxxon before your project for complete warranty information. Technical performance verification and service is available through Maxxon Corporation or Maxxon Regional Representatives throughout North America.



Maxxon Corporation

920 Hamel Road PO Box 253

Hamel, Minnesota 55340

800-238-8461

maxxon.com

info@maxxon.com

 @Maxxon.Corporation

 maxxon-corporation

JOB NAME: _____

DATE: _____

APPLICATOR: _____

Maxxon Corporation assumes no responsibility or liability for any errors or omissions in the content of this document. The information contained is subject to change without notice. Follow local and state regulations and use appropriate safety precautions and measures when installing Maxxon products. See related product literature at Maxxon.com or contact Maxxon Corporation for more information prior to installation.

©2023 Maxxon Corporation. All Rights Reserved. Maxxon and associated logos are registered trademarks of Maxxon Corporation, Hamel, MN, USA. Other trademarks, registered trademarks, product names or logos displayed are the property of their respective owners.