

A photograph of two construction workers in high-visibility yellow vests and blue jeans. They are standing on a construction site, possibly a floor slab, with one worker holding a long, flexible black hose. The background is a plain, light-colored wall.

MAXXON®

FIRE & SOUND MANUAL

JANUARY 2024

DESIGNING FOR SAFETY & SOUND CONTROL

Streamline the process of specifying products to meet your project's requirements for fire safety and acoustical performance. Use this Fire & Sound manual to help determine the right assembly, along with correct codes and resources, based on your project's construction type.

Maxxon® Gyp-Crete® underlayments are available in more than 140 UL and ULC fire-resistance rated designs. Maxxon® Acousti-Mat® products are available in over 140 UL fire-resistant rated designs and backed by thousands of third-party sound tests.

For questions or personalized support, contact Maxxon at (800) 356-7887.





DELIVERING ACOUSTICAL INNOVATIONS

In 1972, Maxxon® revolutionized the construction industry by inventing Gyp-Crete®. We were also the first company to introduce sound mats to Multifamily construction, with our line of Acousti-Mat® products.

Fast forward more than 50 years, and Maxxon continues to lead the way with new technologies and innovations. Today's Acousti-Mat products can be used to mitigate impact and airborne noises in all types of floor goods including LVT, exposed concrete, tile, or hardwood without sacrificing sound control. And our recently launched Commercial Pro VersaTop™ Wear Surface delivers the on-trend look of polished concrete with a streamlined installation process. This innovative hydraulic cement underlayment produces an exposed aggregate surface with no mechanical prep, less grinding, and no polishing.

We recently built North America's largest, accredited floor/ceiling sound transmission test lab, enabling us to measure the lowest frequencies considered for building acoustics, down to 50 Hz. Now we're equipped to develop more products to block a wider range of impact and airborne sounds to meet occupants' increasing demand for acoustical privacy.

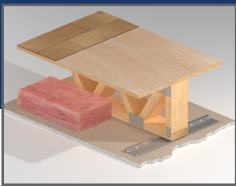

OPEN WEB TRUSS

1 HOUR FIRE DESIGNS

The sound tests below are examples of the many sound tests we have on file. Please refer to the disclaimer on page 14. For assistance determining the right system and UL Fire Rating for your project, contact your Maxxon Regional Representative at (800) 356-7887.

Truss Depth	Insulation	Resilient Channel	Drywall	Min. Topping Depth	Encapsulated Sound Mat	Floor Covering*	Sound Rating			Maxxon UL Fire Ratings	Similar ULs
							STC**	IIC	Test Number		
18"	Yes	Yes	5/8" (16 mm)	3/4" (19 mm)	None	VersoTop	58	35	H6130.01	L528 L529 L534 L546 L542 L558 L562 L563 L574 L576 L577 L579 L581 L583 L585 L592 M500 M503 M508 M510 ICC ESR #2540 UL ER #8477-01	L521 L550
						LVT		41	H6130.02		
						Carpet & Pad		71	I0101.02		
					Acousti-Mat 1/8	VersoTop		47	I0101.06		
						Sheet Vinyl		52	I0101.09		
						LVT	58	50	I0101.07		
						Ceramic Tile		52	I0101.30		
						Carpet and Pad		72	I0101.11		
				1" (25 mm)	Acousti-Mat 1/4	VersoTop		51	I0101.17		
						Sheet Vinyl	59	54	I0106.20		
						LVT		53	I0106.18		
						Ceramic Tile		55	I0106.24		
						Engineered Wood		55	I0106.21		
						Carpet and Pad		71	I0106.22		
					Acousti-Mat 1/4 Premium	VersoTop		53	I0101.14		
						Sheet Vinyl		55	I0101.17		
						LVT	59	54	I0101.15		
						Ceramic Tile		55	I0101.21		
						Engineered Wood		55	I0101.18		
						Carpet and Pad		76	I0101.19		
					Acousti-Mat 3/8	VersoTop		53	I0106.25		
						Sheet Vinyl		56	I0106.28		
						LVT	59	55	I0106.26		
						Ceramic Tile		57	I0106.32		
						Engineered Wood		56	I0107.05		
						Carpet and Pad		75	I0106.30		
					Acousti-Mat 3/8 Premium	VersoTop		54	I0107.25		
						LVT	59	57	I0107.27		
						Ceramic Tile		58	I0107.32		
						Engineered Wood		58	I0107.29		
						Carpet and Pad		79	I0107.30		
				Acousti-Mat 3/4	Acousti-Mat 3/4	Sheet Vinyl		57	I0101.25		
						LVT	59	56	I0101.23		
						Ceramic Tile		59	I0101.29		
						Engineered Wood		57	I0101.26		
						Carpet and Pad		77	I0101.27		
					Acousti-Mat 3/4 Premium	Sheet Vinyl	58	58	I0107.20		
						LVT		59	I0107.19		
						Ceramic Tile		60	I0107.24		
						Engineered Wood		60	I0107.21		
						Carpet and Pad		79	I0107.22		

Other Open Web Truss ULs: For special assemblies and other burn ratings including 2 hr designs, additional Open Web Truss UL Fire Ratings exist. Refer to page 13 for a list of these assemblies.



I-JOIST

1 HOUR FIRE DESIGNS

The sound tests below are examples of the many sound tests we have on file. Please refer to the disclaimer on page 14. For assistance determining the right system and UL Fire Rating for your project, contact your Maxxon Regional Representative at (800) 356-7887.

Truss Depth	Insulation	Resilient Channel	Drywall	Min. Topping Depth	Encapsulated Sound Mat	Floor Covering*	Sound Rating			Maxxon UL Fire Ratings
							STC**	IIC	Test Number	
14"	Yes	Yes	2 Layers 5/8" (2x 16 mm)	3/4" (19 mm)	None	VersaTop	58		TL 96-250	L518 L530 L547 L570 L581 L583 L589 M502 M506 M535 WH J20050694 ICC ESR 1141 ICC ESR 1153 ICC ESR 1305 ICC ESR 1336 ICC ESR 2994 UL ER 8477
VersaTop							29	IN 86-1		
Sheet Vinyl							40	IN 86-2		
Carpet and Pad							70	IN 86-6		
Acousti-Mat 1/8					VersaTop	59	47	I0110.17		
					Sheet Vinyl		50	I0108.09		
					LVT		52	I0110.18		
					Ceramic Tile		50	I0110.24		
					Engineered Wood		51	I0108.10		
					Carpet and Pad		77	I0110.22		
1" (25 mm)				Acousti-Mat 1/4	VersaTop		51	I0109.17		
					Sheet Vinyl	58	55	I0109.20		
					LVT		54	I0109.18		
					Ceramic Tile		56	I0109.24		
					Engineered Wood		56	I0109.21		
					Carpet and Pad		81	I0109.22		
				Acousti-Mat 1/4 Premium	VersaTop		51	I0108.30		
					Sheet Vinyl	59	55	I0108.33		
					LVT		55	I0108.32		
					Ceramic Tile		57	I0108.37		
					Engineered Wood		56	I0108.34		
					Carpet and Pad		83	I0108.35		
				Acousti-Mat 3/8	VersaTop		51	I0110.09		
					Sheet Vinyl	58	56	I0110.12		
					LVT		55	I0110.10		
					Ceramic Tile		59	I0110.16		
					Engineered Wood		58	I0110.13		
					Carpet and Pad		77	I0110.14		
				Acousti-Mat 3/8 Premium	VersaTop		55	I0110.25		
					Sheet Vinyl	61	59	I0110.28		
					LVT		57	I0110.26		
					Ceramic Tile		60	I0110.32		
					Engineered Wood		59	I0110.29		
					Carpet and Pad		84	I0110.30		
Acousti-Mat 3/4					Sheet Vinyl	60	58	I0108.25		
					LVT		57	I0108.24		
					Ceramic Tile		59	I0108.29		
					Engineered Wood		59	I0108.26		
					Carpet and Pad		79	I0108.27		

Other I-Joist ULs: For special assemblies and other burn ratings, additional I-Joist UL Fire Ratings exist. Refer to page 13 for a list of these assemblies.



2X10 JOIST

1 HOUR FIRE DESIGNS

The sound tests below are examples of the many sound tests we have on file. Please refer to the disclaimer on page 14. For assistance determining the right system and UL Fire Rating for your project, contact your Maxxon Regional Representative at (800) 356-7887.

Min. Truss Depth per UL	Insulation	Resilient Channel	Drywall	Min. Topping Depth	Encapsulated Sound Mat	Floor Covering*	Sound Rating			Maxxon UL Fire Ratings
							STC**	IIC	Test Number	
10"	Yes	Yes	5/8" (16 mm)	3/4" (19 mm)	None	None	56	38	I0111.01	L006 L522
						Backed LVT		45	I0111.03	L201 L523
						Carpet and Pad		67	I0111.02	L202 L525
				1" (25 mm)	Acousti-Mat 1/4	VersoTop		46	I0112.17	L206 L526
						Sheet Vinyl	57	51	I0112.20	L209 L533
						LVT		51	I0112.19	L210 L535
						Ceramic Tile		52	I0112.24	L211 L536
						Engineered Wood		51	I0112.21	L212 L537
						Carpet and Pad		73	I0112.22	L501 L539
										L502 L540
										L503 L541
										L504 L545
										L505 L556
										L506 L557

Other 2x10 ULs: For special assemblies and other burn ratings including 2 hr designs, additional 2x10 Joist UL Fire Ratings exist. Refer to page 12 for a list of these assemblies.



HEAVY TIMBER RENOVATION

The sound tests below are examples of the many sound tests we have on file. Please refer to the disclaimer on page 14. For assistance determining the right system for your project, contact your Maxxon Regional Representative at (800) 356-7887.

Truss/Joists	Insulation	Resilient Channel	Drywall	Min. Topping Depth	Encapsulated Sound Mat	Floor Covering*	Sound Rating		
							STC**	IIC	Test Number
Dimensional Lumber	No	No	N/A	N/A	None	VersoTop	30 FSTC		3018-02-31573.7
								33 FIIC	3018-02-31573.5
				1-1/2" (38 mm)	Acousti-Mat 3/4	Tile	47 FSTC		3018-02-31573.6
						Engineered Wood on Pad		52 FIIC	3018-02-31573.4
						Vinyl		46 FIIC	3018-02-31573.3
				1-3/4" (44 mm)+	Acousti-Mat 3/4 + Acousti-Mat SBR	VersoTop	52 FSTC	51 FIIC	30160-04-62432
				3" concrete (76 mm)	Acousti-Mat 3/4 Premium	VersoTop		47 FIIC	D7299.02-13

+1-3/4" is the minimum acceptable pour thickness over Acousti-Mat 3/4 Premium + Acousti-Mat SBR. Assembly tested with 1-1/2" Gyp-Crete topping slab and results should be considered a minimum acoustic performance for the required system.



CONCRETE

1, 2, AND 3 HOUR FIRE DESIGNS

The sound tests below are examples of the many sound tests we have on file. Please refer to the disclaimer on page 14. For assistance determining the right system and UL Fire Rating for your project, contact your Maxxon Regional Representative at (800) 356-7887.

Concrete Depth	Insulation	Resilient Channel	Suspended Ceiling	Drywall	Min. Topping Depth	Encapsulated Sound Mat	Floor Covering*	Sound Rating			Maxxon UL Fire Ratings
								STC**	IIC	Test Number	
4"	No	No	No	No	1" (25 mm)	Acousti-Mat 1/4	VersaTop		50 FIIC	30160-03-57761	J804 J805
					2" (51 mm)	Acousti-Mat 3/4	VersaTop		59 FIIC	30160-03-57761	
6"	No	No	No	No	N/A	Acousti-Top	LVT	52	52	H8289.01	N/A†
							Tile		ΔIIC 22	H8289.01	
										ΔIIC 19	
8"	No	No	No	No	N/A	None	Bare Concrete	62 FSTC		18-0-0607.1	
									39 FIIC	18-0-0607.3	
					1" (25 mm)	Acousti-Mat 1/4	LVT	62 FSTC		18-0-0607.2	
							Hardwood		64 FIIC	18-0-0607.5	
							Tile		60 FIIC	18-0-0607.7	
					1-1/2" (38 mm)	Acousti-Mat 3/8	Tile		61 FIIC	18-0-0607.6	
			2" Concrete (51 mm)	Acousti-Mat 3/4		Tile		65 FIIC	30160-05-72550-7		
				Yes	5/8" (16 mm)	N/A	None	Bare Concrete		70 FIIC	30160-05-72550-9
			VersaTop							61 FIIC	30160-03-56381-5
			N/A			None	Bare Concrete	62 FSTC		30160-06-77973-1	
									42 FIIC	30160-06-77973-2	
			1/2" (13 mm)			Acousti-Top	Hardwood		60 FIIC	30160-06-77870	
							Tile		54 FIIC	30160-06-77870	
			1" (25 mm)			Acousti-Mat 1/4	Tile		60 FIIC	30160-05-67282-2	
			1-1/2" (38 mm)			Acousti-Mat 3/8	Tile		66 FIIC	30160-05-67282-1	
						Acousti-Mat 3/4	Tile		74 FIIC	30160-05-67282-3	

† Fire Ratings over 6" + concrete do not require gypsum concrete.

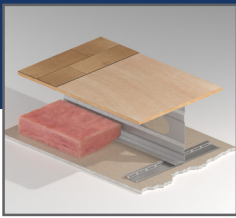

STEEL JOIST/WOOD SUBFLOOR

1 HOUR FIRE DESIGNS

The sound tests below are examples of the many sound tests we have on file. Please refer to the disclaimer on page 14. For assistance determining the right system and UL Fire Rating for your project, contact your Maxxon Regional Representative at (800) 356-7887.

Joist Type	Subfloor	Insulation	Resilient Channel	Drywall	Min. Topping Depth	Encapsulated Sound Mat	Floor Covering*	Sound Rating			Maxxon UL Fire Ratings
								STC**	IIC	Test Number	
Open Web Truss	3/4" Wood Subfloor	Yes	Yes	5/8" (16 mm)	3/4" (19 mm)	Acousti-Mat 1/8	VersoTop	61	43	M3052.12	L527 L564 L567 L573
							LVT		52	M3052.06	
							Engineered Wood		56	M3052.08	
							Tile		50	M3052.10	
							Carpet & Pad		80	M3052.09	
					1" (25 mm)	Acousti-Mat 1/4	VersoTop	61	50	M3052.11	
							LVT		56	M3052.01	
							Engineered Wood		58	M3052.03	
							Tile		55	M3052.05	
							Carpet & Pad		84	M3052.04	
					3/4" (19 mm)	None	Carpet & Pad	51 FSTC		4140-94-2168.1	
									73 FIIC	4140-94-2168.2	
							LVT		49 FIIC	4140-94-2278	
					1-1/2" (38 mm)	Acousti-Mat 3/4	Tile		57 FIIC	FIIC 04-22-1	
							Vinyl		57 FIIC	FIIC 04-22-2	
							Hardwood		58 FIIC	FIIC 04-22-3	
					1" (25 mm)	Acousti-Mat 1/4	Tile		56 FIIC	06-24-1	
							Carpet & Pad		71 FIIC	06-24-2	

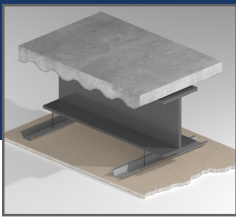

COMPOSITE CONCRETE WITH CORRUGATED STEEL DECK

The sound tests below are examples of the many sound tests we have on file. Please refer to the disclaimer on page 14. For assistance determining the right system and UL Fire Rating for your project, contact your Maxxon Regional Representative at (800) 356-7887.

Concrete Depth	Insulation	Ceiling	Drywall	Min. Topping Depth	Encapsulated Sound Mat	Floor Covering*	Sound Rating			Maxxon UL Fire Ratings
							STC**	IIC	Test Number	
3 1/2" Concrete over Steel Deck	No	Hat Channel Attached to Joist	5/8" (16 mm)	None	None	Bare Concrete	57	28	TL 01-213, IN 01-8	G561
3" Concrete over 9/16" Corrugated Steel Deck	Yes	Wire Hung Grid 17 1/2" Airspace Deck to Ceiling	5/8" (16 mm) Drywall	None	None	Bare Concrete	55	47	3193995CRT-001.8	
				None	Acousti-Top	Engineered Wood		64	3193995CRT-001.5	
			5/8" (16 mm) Ceiling Tile	None	Acousti-Top	Engineered Wood		62	3193995CRT-001.28	
2 1/2" Lightweight Concrete over Steel Deck	Yes	Wire Hung Grid 34" Airspace Deck to Ceiling	5/8" (16 mm)	None	Acousti-Top	Tile		66 FIIC	NAC Centerpoint	D502
				3/8" (10 mm)	Acousti-Top	Engineered Wood		64 FIIC	NAC Centerpoint	
				1" (25 mm)	Acousti-Mat 1/4	Engineered Wood		64 FIIC	NAC Centerpoint	

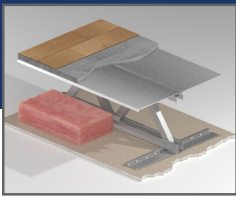

STEEL TRUSS/STEEL DECK

1 AND 2 HOUR FIRE DESIGNS

The sound tests below are examples of the many sound tests we have on file. Please refer to the disclaimer on page 14. For assistance determining the right system and UL Fire Rating for your project, contact your Maxxon Regional Representative at (800) 356-7887.

Subfloor	Insulation	Resilient Channel	Drywall	Min. Topping Depth	Encapsulated Sound Mat	Floor Covering*	Sound Rating			Maxxon UL Fire Ratings	Similar ULs
							STC**	IIC	Test Number		
Steel Deck	Yes	Yes	5/8" (16 mm) Drywall	3/4" (19 mm)	None	VersoTop	56	39	10115.01	G551 [†] G553 [†] G560 [†] G563 [†] G566 [†] G574 [†] G587 G592 G597 H502 M511 ICC ESR # 2540 [†] UL ER # 8477-01 [†]	G564 G577 G578 G579 G580 G581 G582
						Carpet and Pad		73	10115.02		
					Acousti-Mat 1/8	VersoTop	56	42	10117.01		
						Sheet Vinyl		51	10117.04		
						LVT		51	10117.03		
						Engineered Wood		52	10117.05		
						Carpet and Pad		73	10117.06		
				1" (25 mm)	Acousti-Mat 1/4	VersoTop		47	10114.01		
						Sheet Vinyl		53	10114.04		
						LVT	56	52	10114.02		
						Ceramic Tile		55	10114.08		
						Engineered Wood		54	10114.05		
						Carpet and Pad		82	10114.06		
					Acousti-Mat 3/8	VersoTop		50	10115.07		
						Sheet Vinyl		53	10115.10		
						LVT	56	53	10115.09		
						Ceramic Tile		56	10115.14		
						Engineered Wood		55	10115.11		
						Carpet and Pad		80	10115.12		

[†] See UL for specific design detail difference between ratings.



PRECAST HOLLOW CORE CONCRETE

1, 2, AND 3 HOUR FIRE DESIGNS

The sound tests below are examples of the many sound tests we have on file. Please refer to the disclaimer on page 14. For assistance determining the right system and UL Fire Rating for your project, contact your Maxxon Regional Representative at (800) 356-7887.

Concrete Depth	Insulation	Resilient Channel	Suspended Ceiling	Drywall	Min. Topping Depth	Encapsulated Sound Mat	Floor Covering*	Sound Rating			Maxxon UL Fire Ratings
								STC**	IIC	Test Number	
6"	Yes	Yes	Yes	5/8" (16 mm)	1" (25 mm)	Acousti-Mat 1/4	Tile	59		RAL TL 98-108	J917 J919 J920 J924 J927 J931 J957 J958 J991 J994 ICC ESR # 2540 UL ER # 8477-01
8"	No	No	No	None	1/2" (13 mm)	None	Bare Gypsum	58 FSTC		5-896	
							Carpet		75 FIIC	5-896-2	
					3/4" (19 mm)	None	Bare Gypsum		18 FIIC	B2863.13	
							Tile		54 FIIC	B2863.04	
							LVT		56 FIIC	B2863.05	
							Engineered Wood		58 FIIC	B2863.06	
					1" (25 mm)	Acousti-Mat 1/4	Bare Gypsum	61 FSTC		B5011.04	
							Tile		59 FIIC	B5011.04	
							LVT		57 FIIC	B5011.04	
						Acousti-Mat 3/8	Tile		61 FIIC	B2863.07	
							Wood		61 FIIC	B2863.09	

*Contact Maxxon for specific brand, thickness, and installation details. ** All tested assemblies will achieve a minimum of the published result. Specific STC value of the tested assembly listed in the corresponding sound test.



MASS TIMBER

CROSS LAMINATED TIMBER (CLT)

The sound tests below are examples of the many sound tests we have on file. Please refer to the disclaimer on page 14. For assistance determining the right system and UL Fire Rating for your project, contact your Maxxon Regional Representative at (800) 356-7887.

CLT

EXPOSED



DRYWALL DIRECT



SUSPENDED CEILING

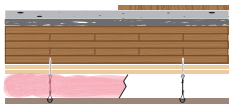

Ceiling Configuration	CLT Assembly	Gypsum Pour	Resilient Channel	Insulation	Encapsulated Sound Mat	Topical Mat	Floor Covering*	Sound Rating			Maxxon UL Fire Ratings
								STC**	IIC	Test Number	
EXPOSED Exposed CLT	5-ply 6-7/8" (175 mm)	2" (51 mm)	None	N/A	Acousti-Mat 3/8 Premium	None	VersoTop	52	38	G2463.01	L901 M533
						2 mm Armstrong Pad	LVT		51	G2463.08	
		Acousti-Mat 3/4 Premium + Acousti-Mat SBR			None	VersoTop	58	49	P4428.01		
					1.4 mm Shaw Pad	LVT		54	P4428.03		
DRYWALL DIRECT 2 Layers 5/8" (16 mm) directly applied to CLT		1" (25 mm)	None	N/A	Acousti-Mat 3/8 Premium	None	VersoTop	52	46	K1279.01	
							LVT		48	K1279.02	
							Engineered Wood		47	K1279.04	
		2" (51 mm) [†]	None	N/A	Acousti-Mat 3/4 Premium + Acousti-Mat SBR	None	VersoTop	59	52	K1277.01	
						Acousti-Top	LVT on Concrete		55	K1277.02	
		SUSPENDED CEILING 2 Layers 5/8" (16 mm) directly applied to CLT + 1 layer 5/8" (16 mm) hung	0.75" (19 mm)	Wire Hung, Armstrong IIC Clip + 6" Air Space	No	Acousti-Mat 1/8	None	VersoTop	59	51	
LVT								54	K1278.02		
Engineered Wood								55	K1278.04		
1" (25 mm)	Yes		Acousti-Mat 3/8 Premium		None	VersoTop	63	60	K1279.05		
						LVT		63	K1279.06		
						Engineered Wood		62	K1279.08		

[†] Normal-weight concrete topping slab.

CLT COMPOSITE

EXPOSED



Ceiling Configuration	CLT Assembly	Gypsum Pour	Resilient Channel	Insulation	Encapsulated Sound Mat	Topical Mat	Floor Covering*	Sound Rating		
								STC**	IIC	Test Number
EXPOSED Composite CLT	2.25" (57 mm) Concrete + 5-ply 5.4" (137 mm) Composite Panel	1" (25 mm)	None	n/a	Acousti-Mat 3/8	None	VersaTop	52	50	K3094.97
							Engineered Wood		52	K3094.69
		1-3/4" (44 mm)+	None	n/a	Acousti-Mat 3/4 Premium + Acousti-Mat SBR	None	VersaTop	56	57	K3094.98
						Acousti-Top	Engineered Wood		61	K4507.06

+1-3/4" is the minimum acceptable pour thickness over Acousti-Mat 3/4 Premium + Acousti-Mat SBR. Assembly tested with 1-1/2" Gyp-Crete and results should be considered a minimum acoustic performance for the required system.



MASS TIMBER

LAMINATED VENEERS (VLT)

The sound tests below are examples of the many sound tests we have on file. Please refer to the disclaimer on page 14. For assistance determining the right system and UL Fire Rating for your project, contact your Maxxon Regional Representative at (800) 356-7887.

VLT

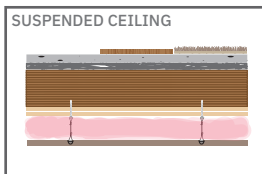
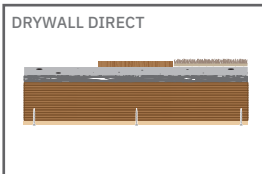

Ceiling Configuration	VLT Assembly	Gypsum Pour	Resilient Channel	Insulation	Encapsulated Sound Mat	Topical Mat	Floor Covering*	Sound Rating		
								STC**	IIC	Test Number
EXPOSED Exposed VLT		2" (51 mm)	No	N/A	Acousti-Mat 3/8 Premium	None	VersaTop		41	L3827.03
							Engineered Wood	52	48	L3827.08
							LVT		45	L3827.04
						2 mm Milliken Pad	LVT		50	P2528.02
							None	Carpet and Pad		83
					Acousti-Mat 3/4 Premium + Acousti-Mat SBR	None	VersaTop		49	L3827.55
							Engineered Wood		53	L3827.60
						Acousti-Top	Engineered Wood	57	54	L3827.61
						None	LVT		52	L3827.56
						Acousti-Top	LVT		54	L3827.57
None	Carpet and Pad		79	L3827.62						
DRYWALL DIRECT 2 Layers 5/8" (16 mm) directly applied to VLT	6-3/8"	2" (51 mm) [†]	No	N/A	Acousti-Mat 3/8 Premium	None	VersaTop		43	L3827.11
							Engineered Wood		48	L3827.16
							LVT		46	L3827.12
						Acousti-Top	LVT	52	50	L3827.13
						None	Carpet and Pad		83	L3827.18
					Acousti-Mat 3/4 Premium + Acousti-Mat SBR	None	VersaTop		51	L3827.63
							LVT		54	L3827.64
						Acousti-Top	LVT		56	L3827.65
						None	Engineered Wood	58	53	L3827.68
						Acousti-Top	Engineered Wood		55	L3827.69
None	Carpet and Pad		79	L3827.70						
SUSPENDED CEILING 2 Layers 5/8" (16 mm) directly applied to VLT + 1 layer 5/8" (16 mm) hung	6-3/8"	1" (25 mm)	Wire Hung, Armstrong IIC Clip + 6" Air Space	No	Acousti-Mat 1/8	None	VersaTop	58	51	L3827.37
							Engineered Wood		54	L3827.39
							LVT		53	L3827.38
		2" (51 mm)			Acousti-Mat 3/8 Premium	None	VersaTop		58	L3827.19
							Engineered Wood	62	59	L3827.23
							LVT		59	L3827.20
		Acousti-Mat 3/4 Premium + Acousti-Mat SBR			None	VersaTop	61	60	L3827.71	
						Engineered Wood		62	L3827.73	
						LVT		62	L3827.72	
		1" (25 mm)	Acousti-Mat 1/8	None	VersaTop	60	61	L3827.45		
					Engineered Wood		64	L3827.47		
					LVT		64	L3827.46		
		2" (51 mm)	Acousti-Mat 3/8 Premium	None	VersaTop	61	61	L3827.27		
					Engineered Wood		63	L3827.31		
					LVT		64	L3827.28		
				Acousti-Mat 3/4 Premium + Acousti-Mat SBR	None	VersaTop	62	64	L3827.79	
Engineered Wood						65	L3827.81			
LVT						66	L3827.80			

*Contact Maxxon for specific brand, thickness, and installation details. ** All tested assemblies will achieve a minimum of the published result. Specific STC value of the tested assembly listed in the corresponding sound test.



MASS TIMBER

DOWEL LAMINATED TIMBER (DLT)

The sound tests below are examples of the many sound tests we have on file. Please refer to the disclaimer on page 14. For assistance determining the right system and UL Fire Rating for your project, contact your Maxxon Regional Representative at (800) 356-7887.

DLT

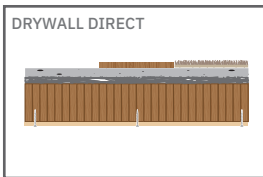

Ceiling Configuration	DLT Assembly	Gypsum Pour (in)	Resilient Channel	Insulation	Encapsulated Sound Mat	Topical Mat	Floor Covering*	Sound Rating				
								STC**	IIC	Test Number		
EXPOSED Exposed DLT	6"	1-1/2" (38 mm)	No	N/A	Acousti-Mat 3/8 Premium	None	VersaTop	54	45	K1274.01		
							LVT		47	K1274.02		
							Engineered Wood		47	K1274.04		
		2-1/2" (64 mm)			Acousti-Mat 3/4 Premium	None	VersaTop	55	45	M8796.02		
						1.5 mm Rubber Mat	LVT		50	M8796.03		
					Acousti-Mat 3/4 Premium + AcoustiMat SBR	None	VersaTop	57	51	Q1631.01		
DRYWALL DIRECT 2 Layers 5/8" (16mm) directly applied to DLT	6"	1-1/2" (38 mm)	No	N/A	Acousti-Mat 3/8 Premium	None	LVT		55	Q1631.03		
							VersaTop	56	47	K1275.01		
							LVT		49	K1275.02		
							Engineered Wood		49	K1275.04		



MASS TIMBER

MASS PLYWOOD PANEL (MPP)

The sound tests below are examples of the many sound tests we have on file. Please refer to the disclaimer on page 14. For assistance determining the right system and UL Fire Rating for your project, contact your Maxxon Regional Representative at (800) 356-7887.

MPP

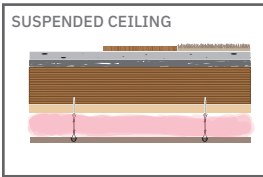
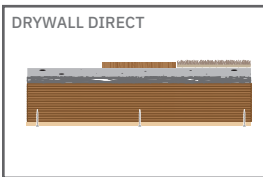
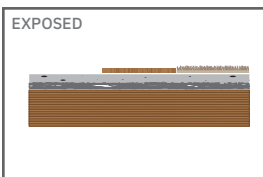

Ceiling Configuration	MPP Assembly	Gypsum Pour (in)	Resilient Channel	Insulation	Encapsulated Sound Mat	Topical Mat	Floor Covering*	Sound Rating		
								STC**	IIC	Test Number
EXPOSED Exposed MPP	5"	1-1/2" (38 mm)	No	N/A	Acousti-Mat 3/4 Premium	None	VersaTop	54	41	K1283.07
DRYWALL DIRECT 2 Layers 5/8" (16mm) directly applied to MPP				No		Acousti-Top	LVT		44	K1283.01
						None	VersaTop	54	44	K1283.08
						Acousti-Top	LVT		46	K1283.02
SUSPENDED CEILING 2 Layers 5/8" (16mm) directly applied to MPP + 1 layer 5/8" (16 mm) hung			Wire Hung, Armstrong IIC Clip + 6" Air Space	No		None	VersaTop	61	52	K1283.03
						None	LVT		55	K1283.04
		None			Engineered Wood		55	K1283.06		
EXPOSED Exposed MPP		2" (51 mm)†	No	N/A	Acousti-Mat 3/4 Premium + Acousti-Mat SBR	None	VersaTop	57	47	K1282.01
						Acousti-Top	LVT on Concrete		51	K1282.02

[†] Normal-weight concrete topping slab.

MISCELLANEOUS UL FIRE DESIGNS

OPEN WEB TRUSS

UL #	Unique Assembly Details
L529	Suspended Ceiling
L542	Furring Channels/Drywall Screwed Direct
L556	2HR/4 Layers of Drywall
L577	2HR/3 Layers of Drywall
L581	Kinetics ICW Clip, Batt Insulation, 2 Layers 5/8" Gypsum Board
L583	Kinetics Isomax Clip, Batt Insulation, 2 Layers of 5/8" Gypsum Board
M500	2HR/3+ Layers of Drywall
M510	2HR/3 Layers of Drywall - 1 Layer Screwed Direct

2X10

UL #	Unique Assembly Details
M504	0.75 HR/Drywall Screwed Direct
M514	Sound Break Gypsum Board from National Gypsum
L581	Kinetics ICW Clip, Batt Insulation, 2 Layers 5/8" Gypsum Board
L583	Kinetics Isomax Clip, Batt Insulation, 2 Layers of 5/8" Gypsum Board

ULC DESIGN

#	Hour Rating	Type of Construction
I530	1.5, 2	TotalJoist by iSPAN®
L003	1	2" x 10" Wood Joist
L201	1	2" x 10" Wood Joist
L511	2	2" x 10" Wood Joist
L512	1	2" x 10" Wood Joist (Commercial Construction Only)
M500	1	2" x 10" Wood Joist
M501	1	2" x 10" Wood Joist
M503	2	2" x 10" Wood Joist
M514	2	Open Web Truss or Steel Frame
M520	1	TotalJoist by iSPAN®
M521	1	TotalJoist by iSPAN®

Canada also accepts all UL Fire Designs listed in this manual. For verification of a UL Fire Design for Canada, refer to the UL Environment document CCOX7.R8477 "Floor- and Roof-topping Mixtures Certified for Canada", which can be obtained by contacting your Maxxon Regional Representative or at www.ul.com.

For assistance determining the right systems and UL Fire Rating for your project, contact your Maxxon Regional Representative at (800) 356-7887.

I-JOIST

UL #	Unique Assembly Details
L518	TJI®/Resilient Channel
L530	TJI®/Simpson Strong Clips
L538	2HR/3 Layers of Drywall
L547	TJI®/Resilient Channel
L556	2HR/Wilamette I Beam Truss/4 Layers of Drywall
L581	Kinetics ICW Clip, Batt Insulation, 2 Layers 5/8" Gypsum Board
L583	Kinetics Isomax Clip, Batt Insulation, 2 Layers of 5/8" Gypsum Board

STEEL JOIST

UL #	Steel Joist Manufacturer
G230	2HR/Midcon MetalEdge concrete T&G plank
G516	2HR/Midcon MetalEdge concrete T&G plank
G592	1, 2HR/Plycem Board
H502	1, 1½, 2HR/Plycem Board



ADDITIONAL INFORMATION

MAXXON STANDARD UNDERLAYMENTS Evaluation Report R8477	MAXXON HIGH-STRENGTH UNDERLAYMENTS Evaluation Report R8477	MAXXON ENCAPSULATED SOUND MATS Evaluation Report R8477
<ul style="list-style-type: none"> • Maxxon Gyp-Crete® Basic • Maxxon Gyp-Crete® 2000 Multifamily • Maxxon Gyp-Crete® Radiant • Maxxon Rapid Floor® Basic • Maxxon Rapid Floor® Multifamily 	<ul style="list-style-type: none"> • Maxxon Gyp-Crete® High Performance • Maxxon Commercial Pro Level-Right® • Maxxon Commercial Pro Level-Crete™ • Maxxon Commercial Level EZ™ • Maxxon Commercial EZ Crete™ • Maxxon Commercial Gyp-Fix EZ™ 	<ul style="list-style-type: none"> • All Maxxon Acousti-Mats® • Maxxon Acousti-Top®

NOTE REGARDING CANADIAN PROJECTS: Canada accepts all UL Fire Designs listed in this manual. For additional information on Canadian Fire Designs, refer to page 13.

DISCLAIMER: For complete assembly information for a specific fire design, click on the UL number or visit Underwriters' Laboratories website. While the assemblies of the sound tests were constructed to best represent the most commonly built version of the UL fire design, some variances in construction may have occurred (i.e. within a particular UL rating there can be the allowances for different joist spacing and joist depths, different thicknesses and types of insulation or even no insulation, different types of channel, etc). The sound tests are a representation of what can be expected for sound control ratings when building a floor/ceiling assembly with a specific floor joist assembly that relates to a UL fire design using the designated sound control mat. However, due to the many variables beyond our control (for example quality control of drywall installation, type of resilient channel, density and selection of other building materials, flanking paths, etc.), the sound tests in this resource should not be considered a guarantee of performance. For this same reasoning and the fact that the sound tests were run in different buildings, different laboratories, and different environments, this data can be used for comparison and design evaluation but should not be considered a guarantee of performance. All acoustical testing was done by Architectural Testing; Riverbank Testing Laboratories; Intest, Inc.; Intertek Laboratories; Twin City Testing Corporation; D.L. Adams Associates, L.T.D.; Veneklasen Associates; or Stewart Acoustical Consultants. For assistance determining the right system and UL Fire Rating for your project, contact your Maxxon Regional Representative at (800) 356-7887.





MAXXON®

920 Hamel Road PO Box 253
Hamel, Minnesota 55340
800-356-7887

maxxon.com

info@maxxon.com



Underwriters
Laboratories Inc.
Listed



 @Maxxon.Corporation
 maxxon-corporation



©2024 Maxxon Corporation. All Rights Reserved. Maxxon, Gyp-Crete, Level-Right, Level-Crete, Level EZ, EZ Crete, Acousti-Mat, Acousti-Top, VersaTop and associated logos are registered trademarks of Maxxon Corporation, Hamel, MN, USA. TJI Joists are manufactured by and are registered trademarks of Trus Joist MacMillan. Thermafiber, Sheetrock and Firecode C are trademarks of US Gypsum Company. SpaceJoist is a registered trademark of Truswal Systems Corporation. TotalJoist by iSpan is a trademark of Genesis TP. Printed in the USA. M-002.